

Glide 300 Parts Profile

Product Number: 200801-03A - Glide 300
201001-03A - Glide wispa 300

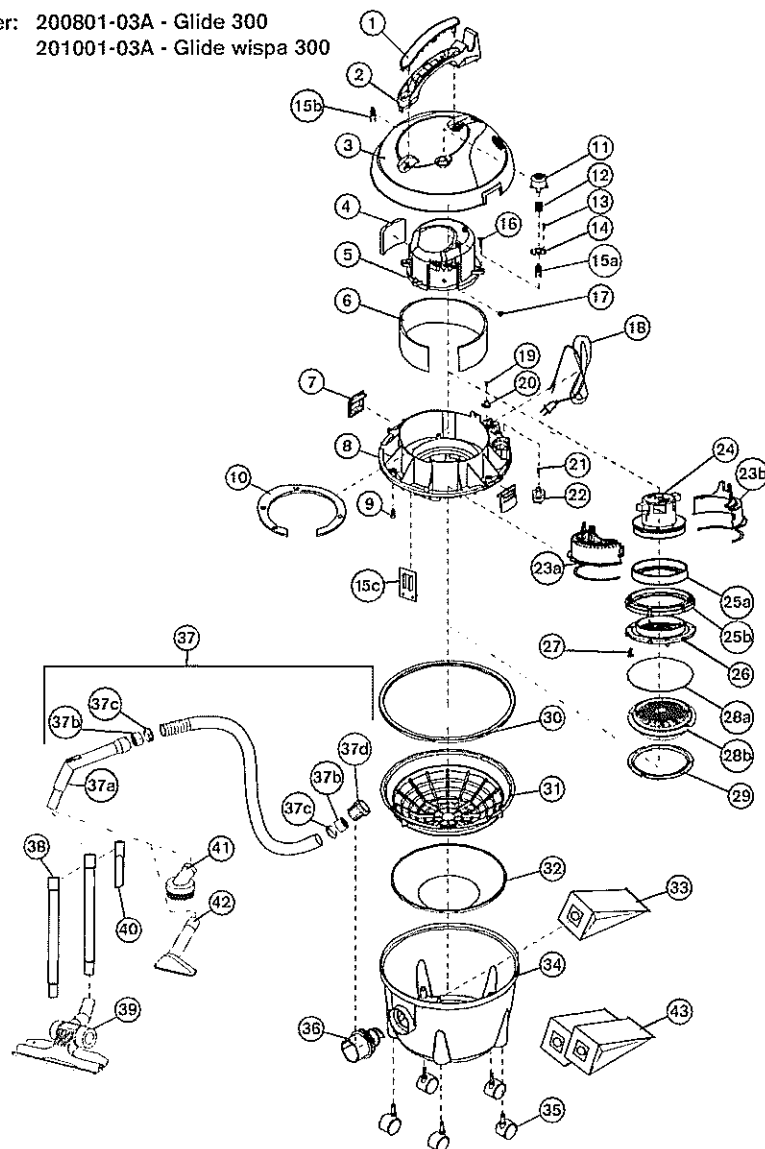

Quote these part numbers when ordering spare parts

No.	Part Name	Part No.	No.	Part Name	Part No.
1.	Handle cover	G103	25a.	Motor gasket	G253
2.	Handle base	G105	25b.	Motor housing gasket	G253B
3.	Top cover	G107B	26.	Air inlet grill V2	G26B
4.	Exhaust filter	G259	27.	Screw ST 4x16	G15
5.	Motor housing	G256	28a.	Motor filter	G522
6.	Noise insulation motor	G254	28b.	HEPA filter	G288
7.	Latch each V3	G131C		Supplied in Glide wispa 300	
8.	Middle base V2	G115B		Optional extra for Glide 300	
9.	Screw 5x30	G10	29.	Cuff for air inlet grill	G29
10.	Noise insulation ring	G255		Not required in Glide wispa 300	
11.	On off button	G2612	30.	Seal for SMS Filter	G126
12.	Spring for switch	G435	31.	Retainer for SMS Filter V2	G127B
13.	Screw 3x8	G11	32.	SMS filter	G128
14.	Switch pedal	G260	33.	Glide dustbag	G129
15a.	Switch	G261	34.	Main cannister	G252
15b.	Switch two speed 10A 250V	G261W	35.	Castor wheel	G145
	Note: Glide wispa 300 model only.		36.	Suction pedestal V2	G138B
15c.	Two speed PCB board V2	G2SV2	37.	Hose complete V3 32mm 2m	G32C
16.	Screw ST 5x23	G12	37a.	Bent hand piece 32mm	KC330
17.	Two hole stopple	G17	37b.	Hose cuff hull 32mm	UA914
18.	Power cord 18m 10A 2c 1mm ²	G108	37c.	Hose clip ring 32mm	UA915
19.	Screw ST 4x12	G13	37d.	Machine end connector 32mm	KC200
20.	Pedal for power cord	G262	38.	Two piece wand 32mm	KC9092
21.	Screw ST 3x6	G14	39.	Combination floor tool with wheels 32mm x 285mm	UA908W
22.	Thermal cut-out	G01A	40.	Crevice Tool 32mm	KC911
23a.	Right motor bracket	G276R	41.	Dusting Brush 32mm	KC910
23b.	Left motor bracket	G276L	42.	Upholstery tool 32mm	KC912
24.	Motor 240V 1300W single stage flow through	G118	43.	Glide paper bag (Packet of 5)	KC286

Glide 300 Specifications

Volts / Frequency: 220-240V~50Hz
 Motor: 240V 1300W Single Stage Flow Through
 Noise Level: 64dB(A) ±3dB(A) (at 1.5m)
 Filtration: 3 stage
 Airflow Volume: 38 litres per sec
 Tank: Capacity: 15 litres
 Weight: 5.8kgs

Glide wispa 300 Specifications

Volts / Frequency: 220-240V~50Hz
 Motor: 240V 1300W Single Stage Flow Through
 Noise Level: Normal mode: 64dB(A) ±3dB(A) (at 1.5m)
 wispa mode: 60dB(A) ±3dB(A) (at 1.5m)
 Filtration: 3 stage, 99.99% efficiency at 0.3 micron
 Airflow Volume: 38 litres per sec
 Tank Capacity: 15 litres
 Weight: 5.9kgs

Technical specifications, part numbers and parts profiles are subject to change without notice.