

# Numatic

## NX 300



# NUC244NX

## COMPACT SCRUBBER DRYER

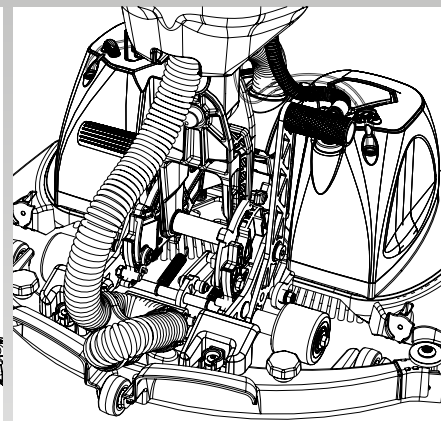
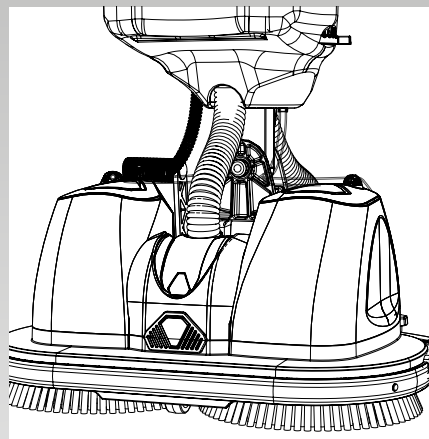

## Original Instructions



CAUTION, Read instructions before using the machine



**Nu-Assist**

Download on the  
App Store

ANDROID APP ON  
Google play



numatic.com

# COMPACT SCRUBBER DRYER

## NUC244NX

Index

|   |             |
|---|-------------|
| <b>Machine Overview</b>   | Pages 1 & 2 |
| <b>Control Panel Overview</b>                                   | Page 3      |
| <b>Quick Set up Guide</b>                                       | Page 4      |
| Brush fitting   | Page 4      |
| Main tank assembly removal                                      | Page 4      |
| Clean water tank removal & filling                              | Page 5      |
| Battery fitting & water flow setting                            | Page 6-7    |
| Machine handle operation  | Page 7      |
| Storage & Transportation  | Page 8      |
| <b>Regular maintenance</b>                                      | Page 9      |
| Separator removal & cleaning                                    | Page 9      |
| Clean water tank outlet cleaning                                | Page 9      |
| Float valve removal & cleaning                                  | Page 10     |
| <b>Emptying Tanks</b>   | Page 10     |
| <b>Changing the floor-tool blades</b>                           | Page 11     |
| Refitting the floor-tool blades                                 | Page 11     |
| <b>Battery removal &amp; charging</b>                           | Page 12     |
| Removing the battery  | Page 12     |
| Battery Charging  | Page 12     |
| Twintec Maintenance   | Page 12     |
| <b>Specifications</b>   | Page 13     |
| <b>Troubleshooting</b>  | Page 13     |
| <b>Rating Label / Personal Protective Equipment / Recycling</b> | Page 14     |
| <b>Safety Precautions</b>                                       | Page 15     |
| Recommended Spare Parts   | Page 16     |
| Schematic Diagram   | Page 16     |
| EU Declaration Document   | Page 17     |
| Warranty  | Page 18     |
| Company Address   | Page 19     |

**PLEASE READ  
BEFORE COMMENCING  
OPERATION.  
KEEP FOR FUTURE REFERENCE**

After the removal of all the packaging,  
carefully open and check the contents

- Owner Manual
- Battery Charger & Lead
- Battery Pack • Scrub Brushes x 2
- Squeegee Assembly

| Machine Overview |                                    |
|------------------|------------------------------------|
| 1                | Operator control panel             |
| 2                | Triggers                           |
| 3                | Waste-water tank                   |
| 4                | Clean-water tank                   |
| 5                | Brush deck                         |
| 6                | Squeegee blades                    |
| 7                | Clean water flow adjustment taps   |
| 8                | Clean-water filling / emptying cap |
| 9                | Floor-tool vacuum hose             |
| 10               | Vacuum hose                        |
| 11               | Separator                          |
| 12               | Battery                            |
| 13               | Battery charger                    |
| 14               | Clean tank fill view windows       |
| 15               | Storage lever                      |
| 16               | Floor-tool release lever           |
| 17               | Transport / Storage wheels         |

## Machine Overview

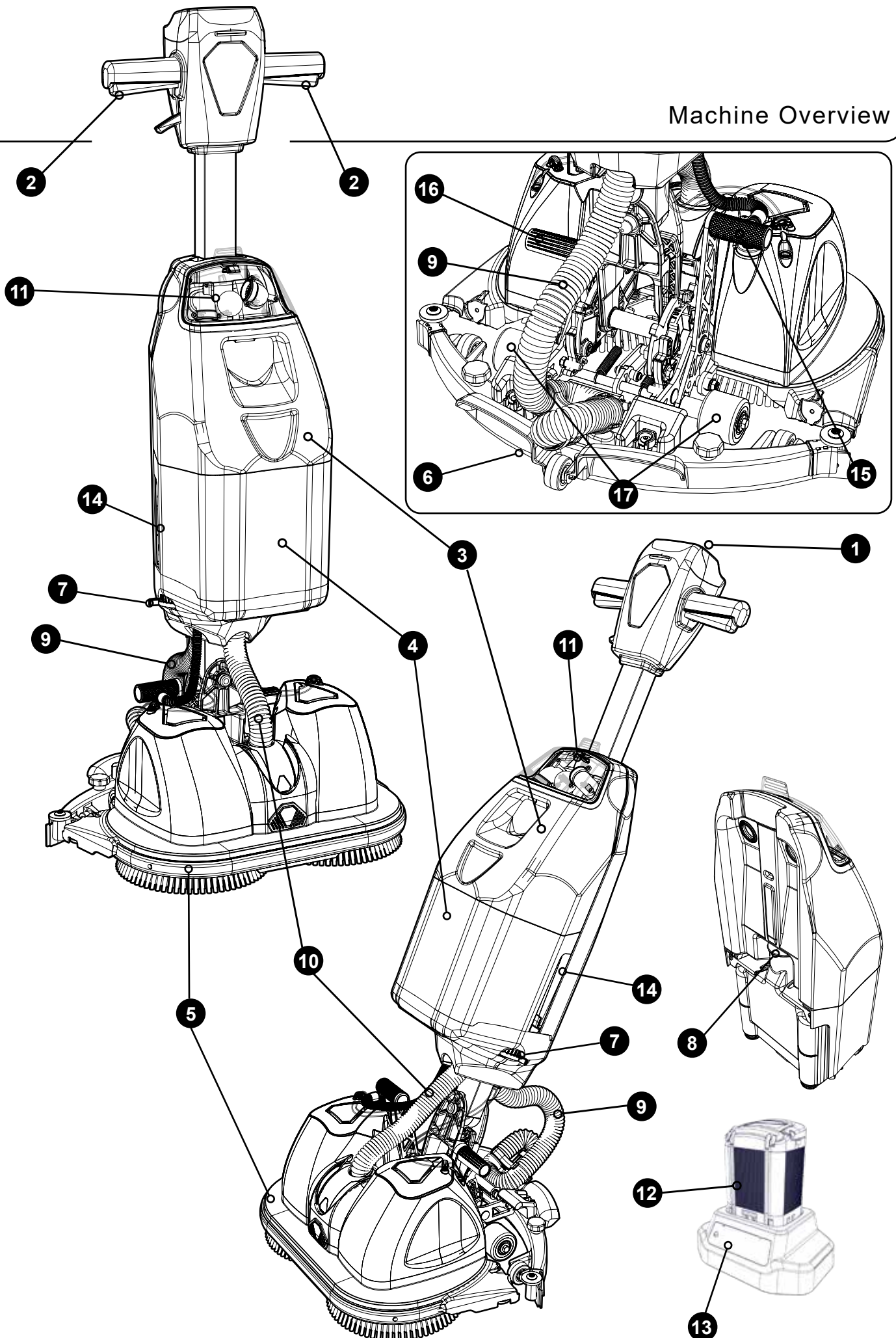

## COMPACT SCRUBBER DRYER

# NUC244NX

### Control Panel Overview

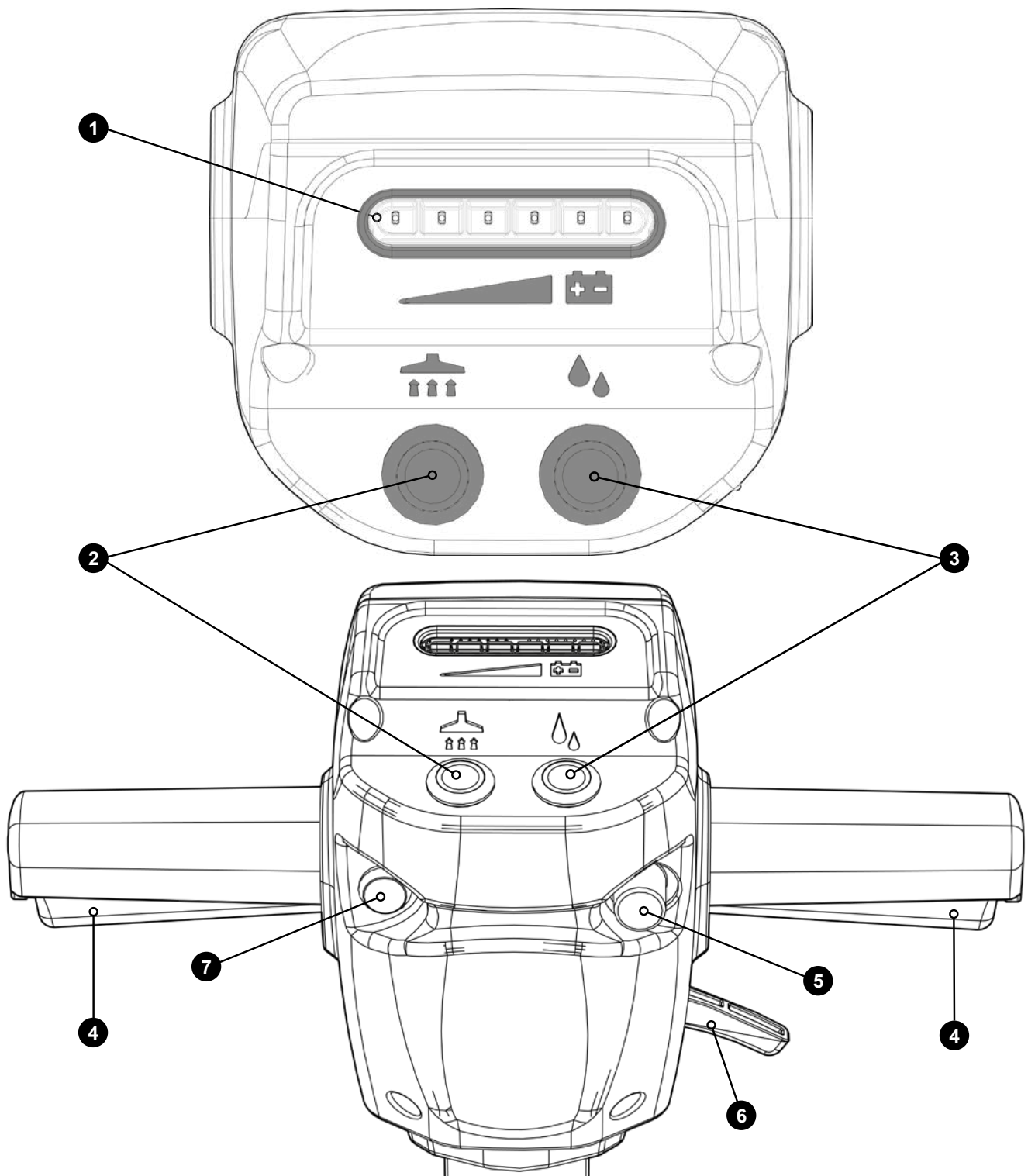

|   |  |
|---|--|
| 1 | Battery Charge Level Meter                   |
| 2 | Vacuum On / Off                              |
| 3 | Water Flow On / Off                          |
| 4 | Triggers                                     |
| 5 | Handle Lock Button (In the upright position) |
| 6 | Handle Release Lever                         |
| 7 | Start Button                                 |

*In the event of a breakdown contact  
your Numatic dealer or the  
**Numatic Technical**  
help line +44 (0)1460 269268*





**PLEASE READ BEFORE COMMENCING ANY OPERATION. AFTER THE REMOVAL OF ALL THE PACKAGING, CAREFULLY OPEN AND CHECK THE CONTENTS.**



## NUC244NX CONTENTS

- Owner Manual
- Battery Charger & Lead
- Battery Pack
- Scrub Brushes x 2
- Squeegee Assembly

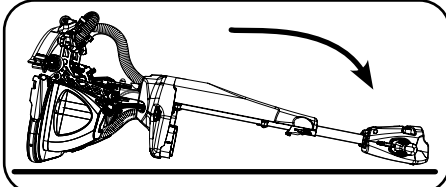

Make sure the handle is locked in upright position and storage wheels are retracted. Remove the tank assembly (and battery if fitted) gently lay machine on its front

## Floor tool and vacuum hose fitting

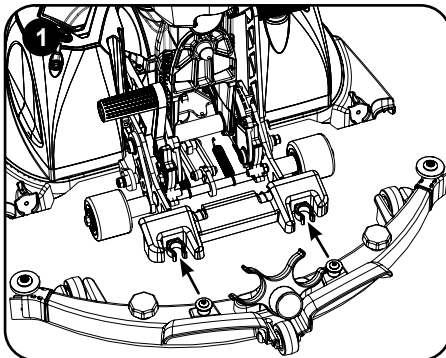

Push the floor tool carrier handle down and push the floor tool onto the retaining clips (1 & 2).

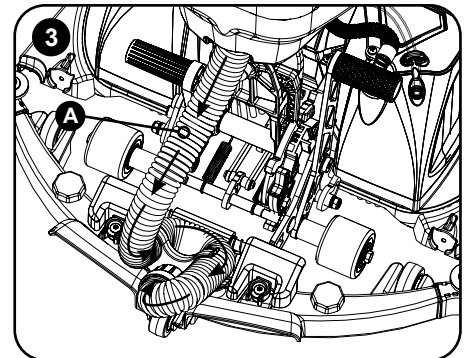
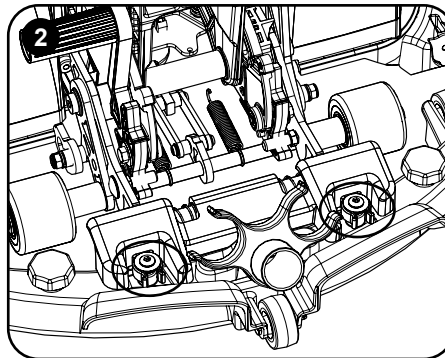

Take the hose and fit it into the hose retaining clips then push the open end securely over the centre fitting on the floor tool. Follow the arrows for the correct fit. Make sure part (A) of the hose stays loose and is not over stretched.

## Main tank assembly removal

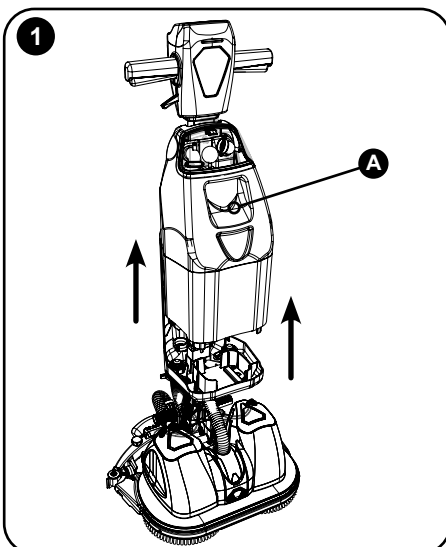

Remove the tank assembly from the front of the machine. Using the inset handle on the front of the tank assembly (A), lift the tank assembly up towards the main handle.

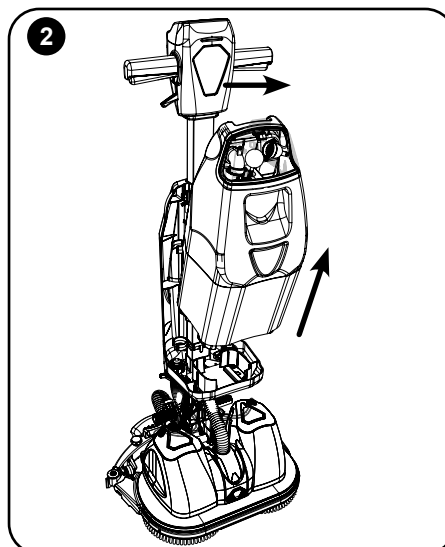

Lift and tilt the top of the tank assembly away from the handle as you remove. Place the tank assembly on a suitable surface in its upright/uppermost position.

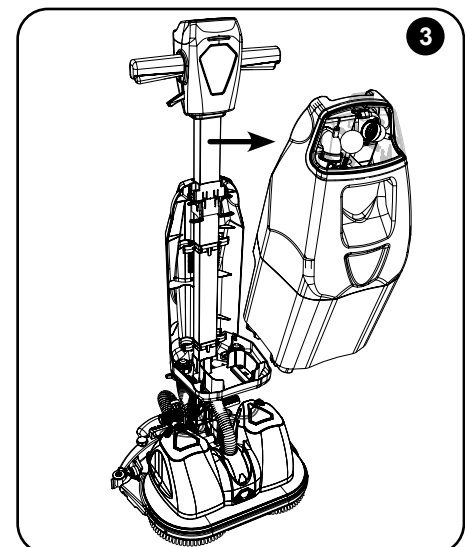

## Quick Set-up Guide

### Clean water tank removal and filling

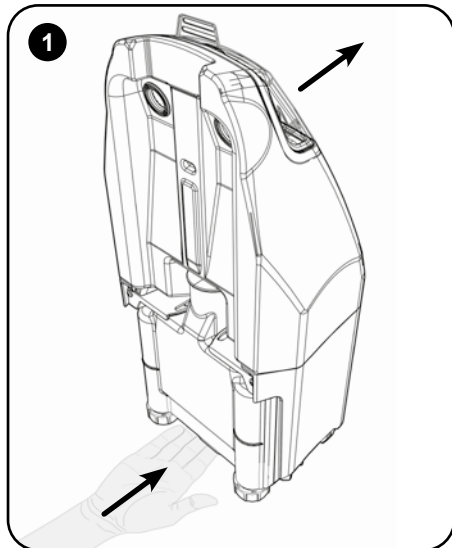

After lifting onto a suitable work surface, tilt the tank assembly slightly forward and slide your hand under the tank.

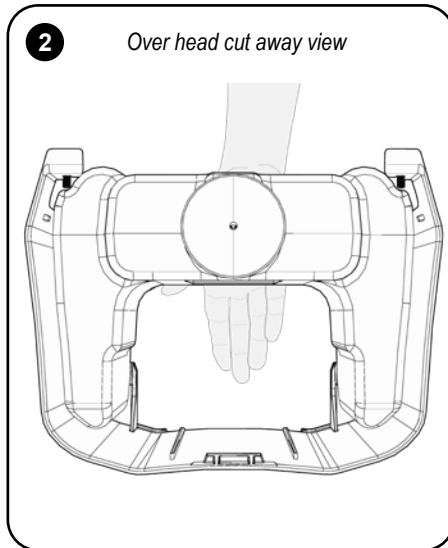

Slide your hand under the tank and curl your fingers up in the space in front of the tank, use your fingers to pop the tank out.

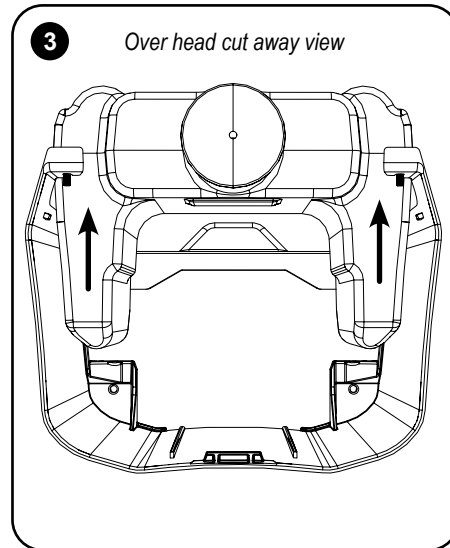

Remove the clean water tank from the main body of the tank holder.

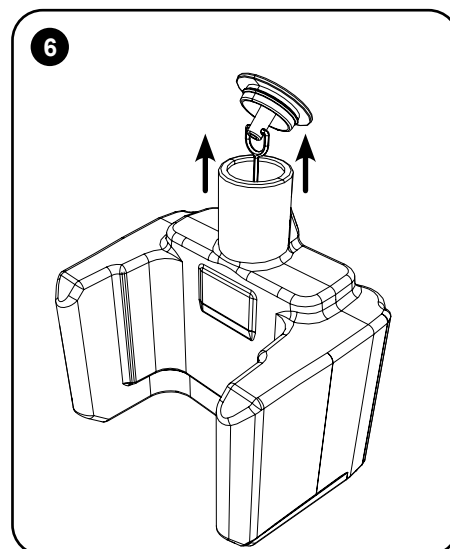
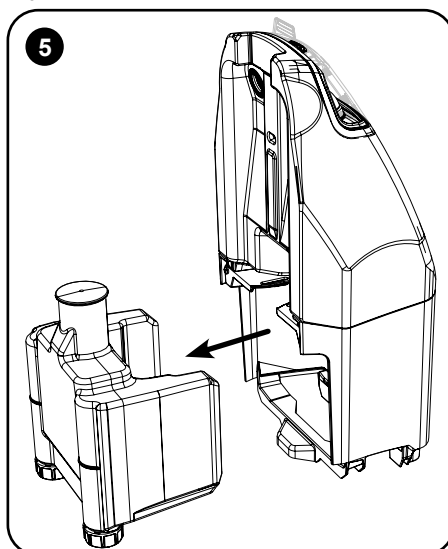
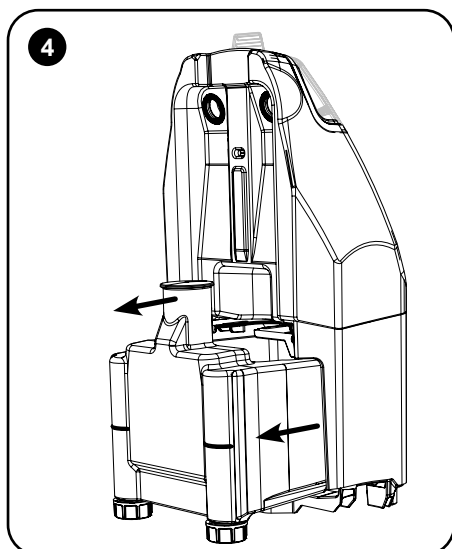

Remove the clean water tank from the main body of the tank holder (4&5). To fill remove the rubber stop from the filling neck.  
Note: There is a T piece keeping the rubber stop from being completely removed.

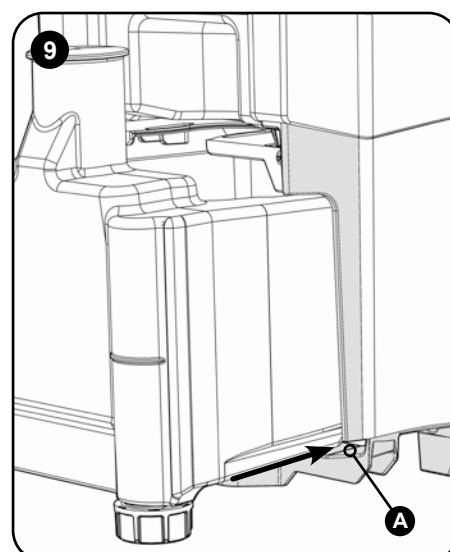
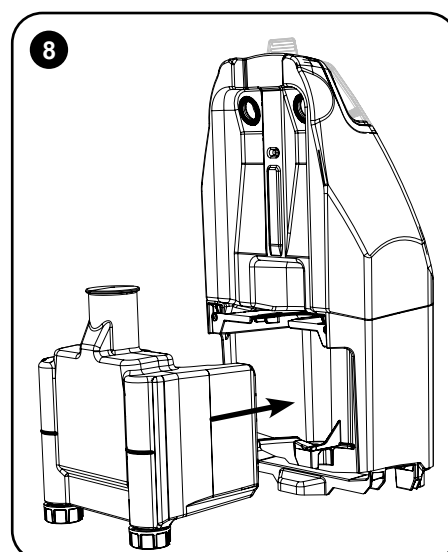
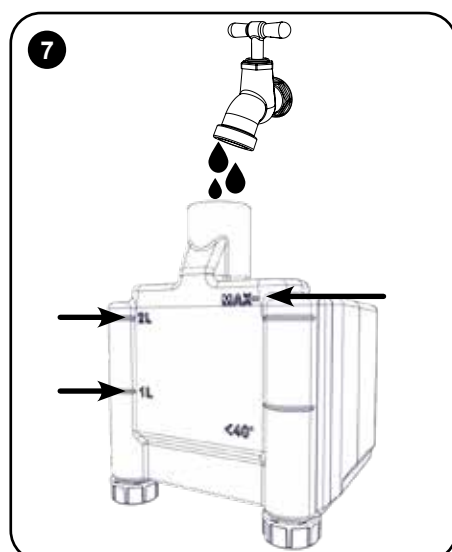

Pour in the chemical (follow chemical manufactures dilution rates). Only fill the tank to the MAX fill line with clean water using a tap, hose or suitable water container. DO NOT OVER FILL. Slide the tank back into the main tank body, make sure the front of the clean water tank is lifted to enter the recess (A). Push the tank all the way in until you hear it click, make sure it is securely fitted before fitting the tank assembly back on the machine.

## Battery fitting and Water flow setting

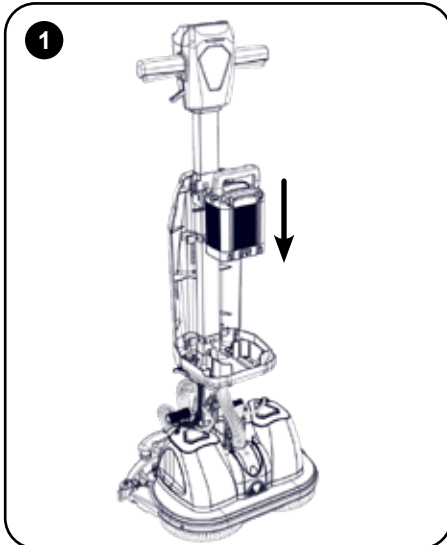

1 Lift the battery using the battery handle. Place the battery into the battery compartment ensuring it is securely in place and the orientation is correct (battery handle folds down towards the machine handle (A)).

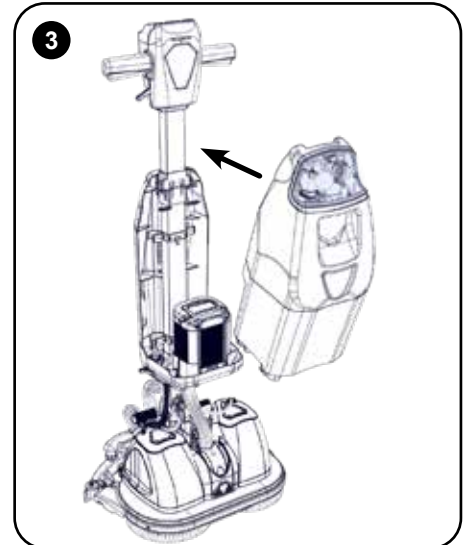
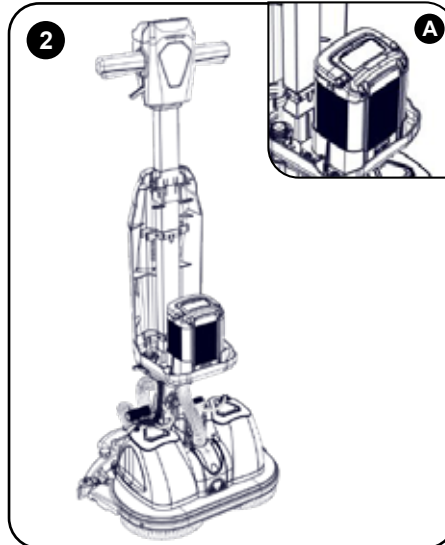

3 Refit the main tank onto the machine.

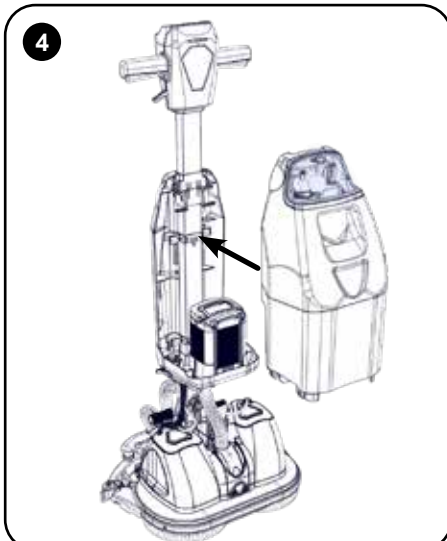

4 Tilt the bottom of the tank towards the handle above the battery.

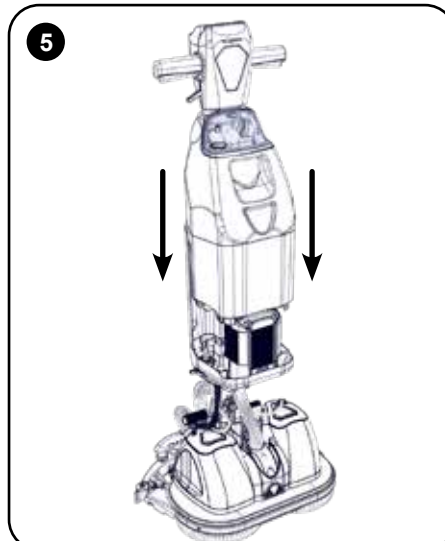

5 Line the tank up against the machine handle and lower the tank down. Make sure it is securely fitted.

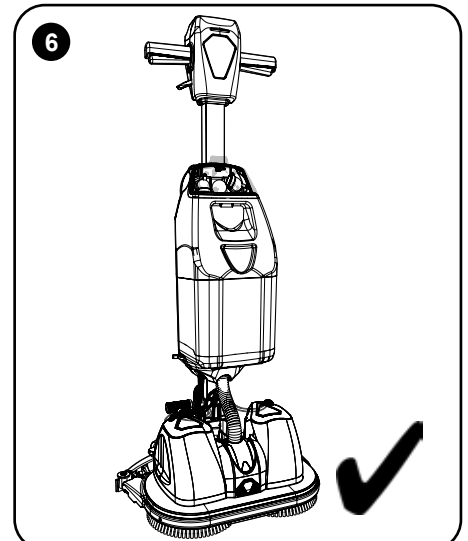

6 Clean water tank full and fitted to the machine.

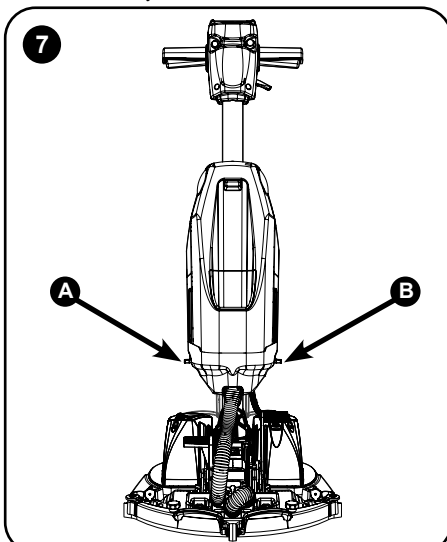

7 Located on the left and right side of the machine are the individual water taps for each brush.

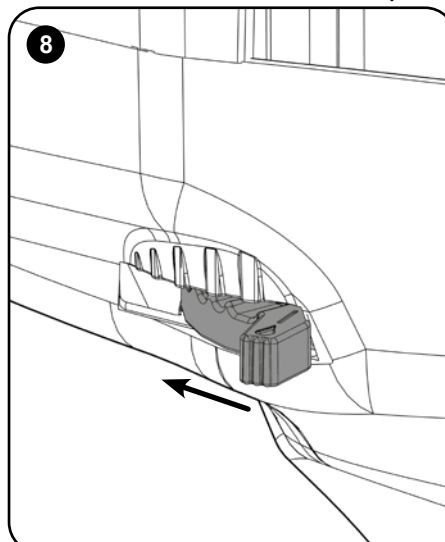

8 Push the fluid control levers on the Left and Right of the machine to set the desired flow required, this will vary depending on what brush / pad and floor type the machine is being used on. *Note: On first use open the water taps fully and run the machine for a short period to purge the water flow then adjust taps to desired flow. Make sure each lever is set to the same position.*

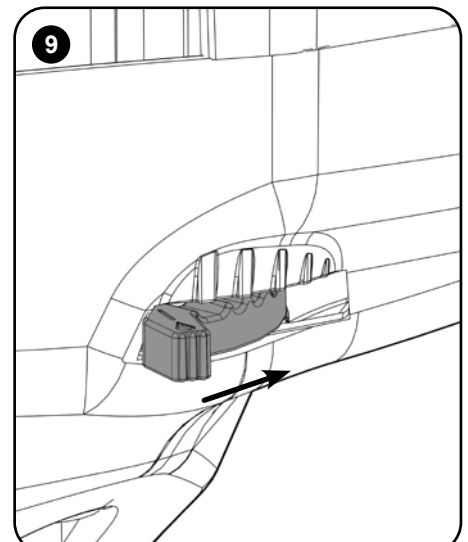



## Quick Set-up Guide

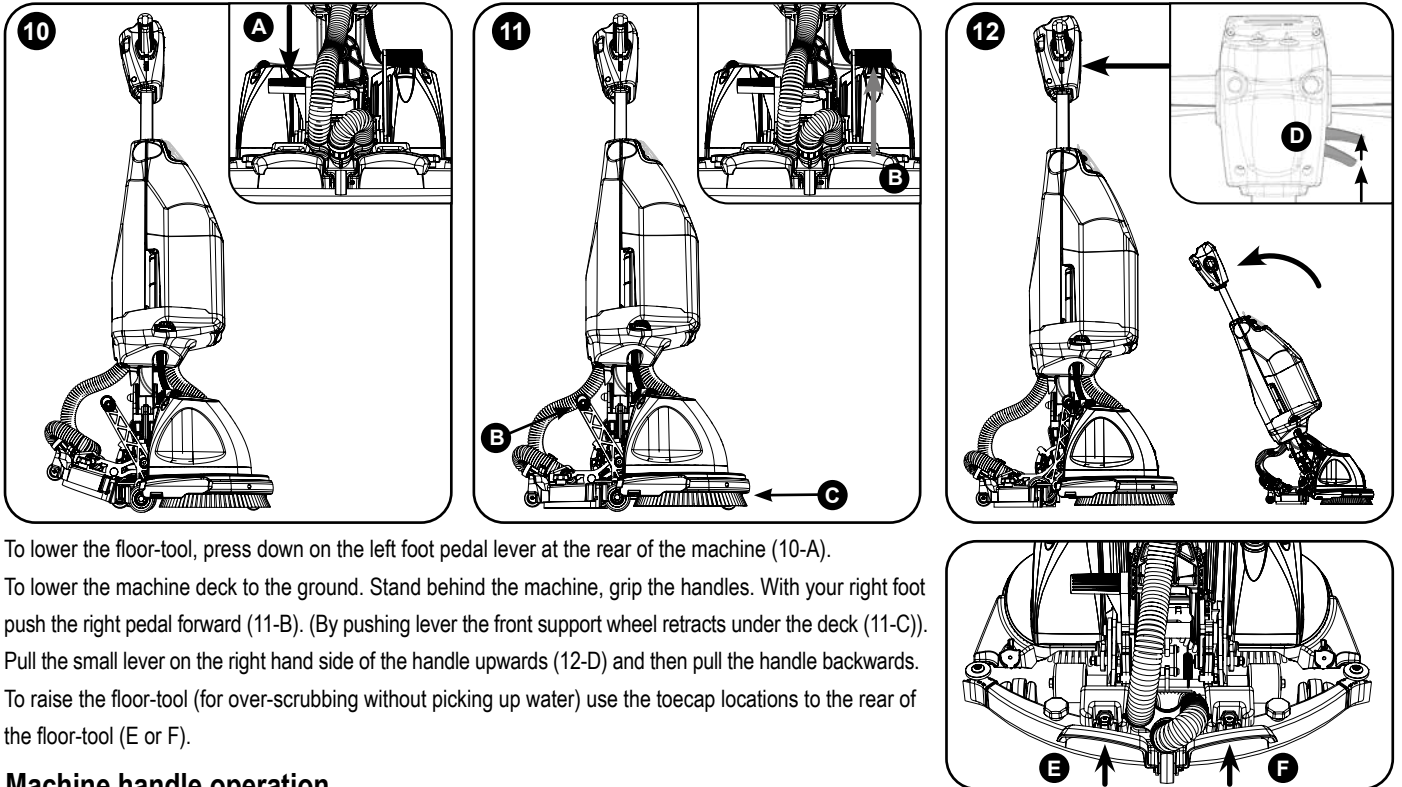

To lower the floor-tool, press down on the left foot pedal lever at the rear of the machine (10-A).

To lower the machine deck to the ground. Stand behind the machine, grip the handles. With your right foot push the right pedal forward (11-B). (By pushing lever the front support wheel retracts under the deck (11-C)).

Pull the small lever on the right hand side of the handle upwards (12-D) and then pull the handle backwards.

To raise the floor-tool (for over-scrubbing without picking up water) use the toecap locations to the rear of the floor-tool (E or F).

### Machine handle operation

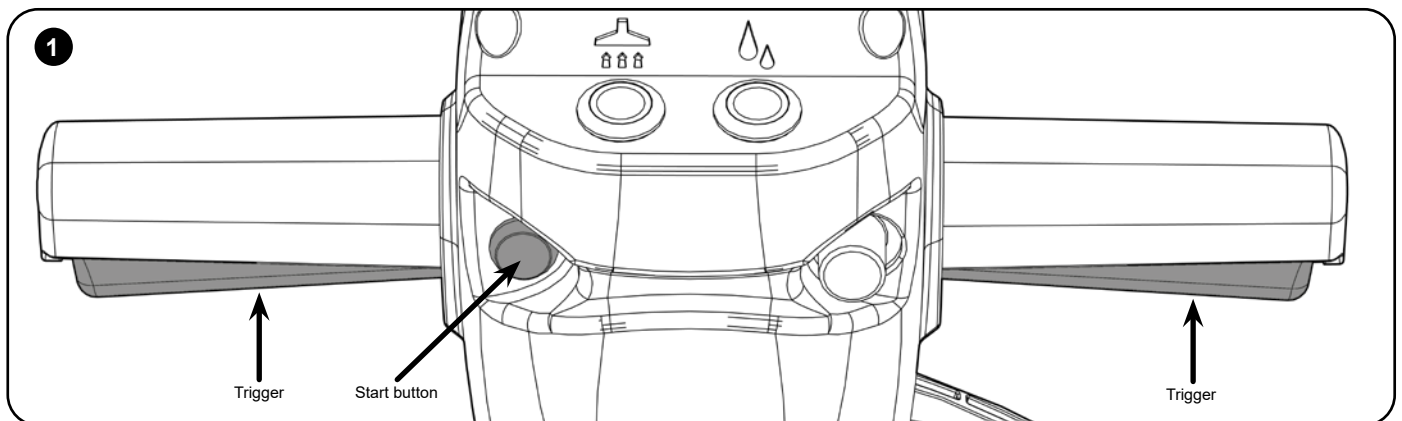

To start the machine pull one or both triggers in and press the start button with the deck down, this will start the brushes spinning and the battery power indicator will illuminate to show the power level.

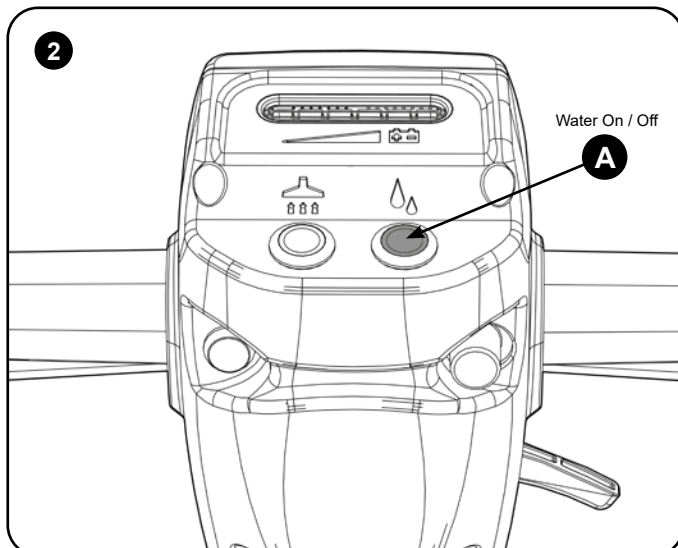

With either trigger pulled in press the water on button, this lights up blue to indicate it is on.

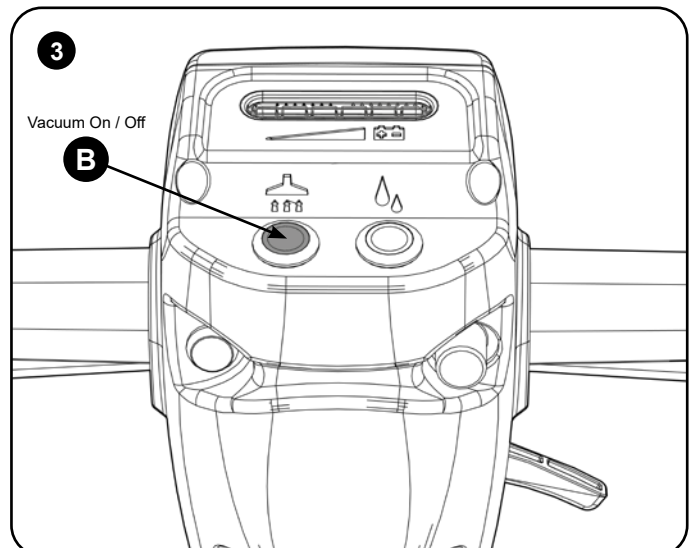

Press the vacuum on button, this lights up blue to indicate it is on and the vacuum starts. You are now ready to start cleaning.

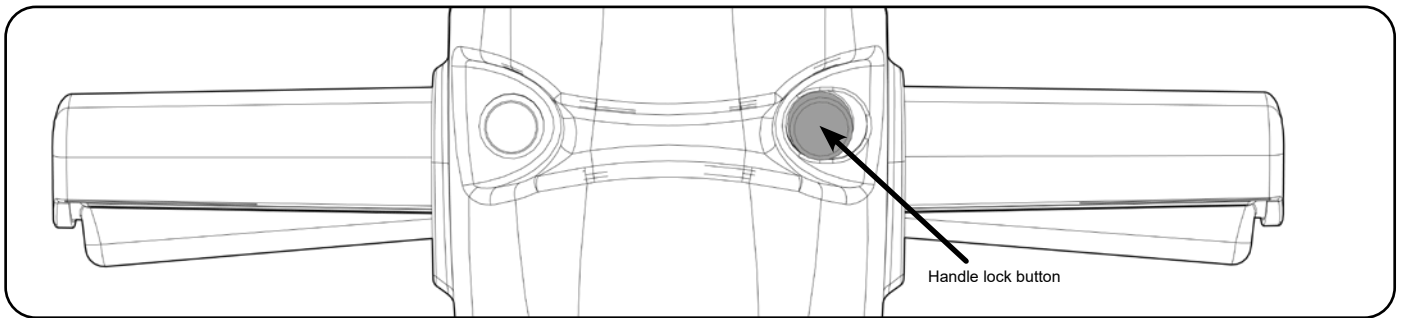

Make sure the handle is in the upright position and locked in place, push the handle lock button and locate handle in correct position.

## Storage and Transport mode option 1

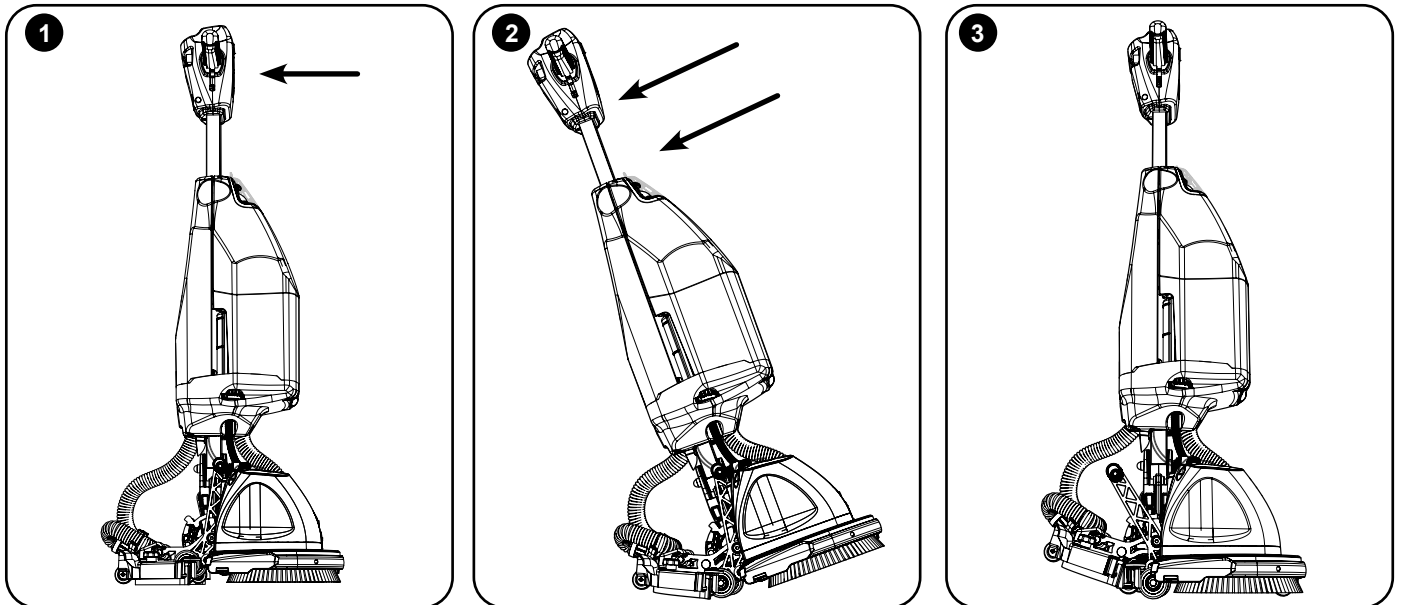

To put the machine into storage mode start with the handle locked in the upright position and the floor-tool down (1), pull the handle backwards until the floor-tool moves up and the transport wheels click out into position the front support wheel is deployed (2). Rest the machine back onto the transport wheels (3) (no button or lever action is required). Note: Do not let go of the handle.

## Storage and Transport mode option 2

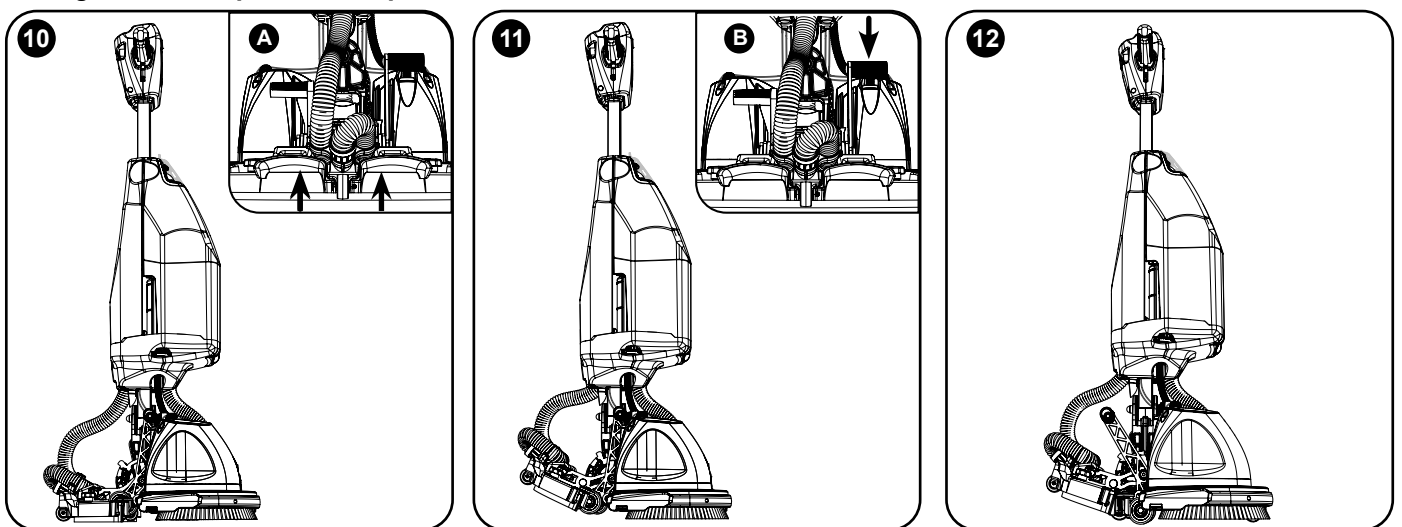

To raise the floor-tool use the toecap locations to the rear of the floor-tool and lift up (A). To raise the machine deck off the ground. Stand behind the machine, grip the handle. With your right foot push the right pedal down (B) while pulling the machine backwards until the storage wheels click into position and the front support wheel extends.



**MAKE SURE THE HANDLE IS LOCKED IN THE UPRIGHT POSITION  
BEFORE LETTING GO OF THE HANDLE.**





## Regular Maintenance

### Separator removal and cleaning

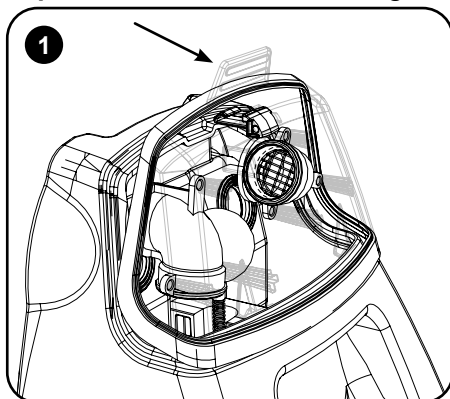

Using thumb and index finger grip the tab of the separator and pull forwards.

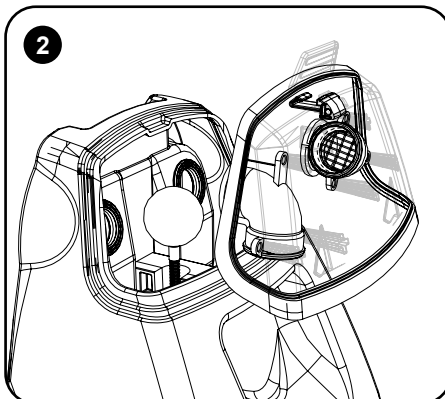

Lift the separator away from the tank.

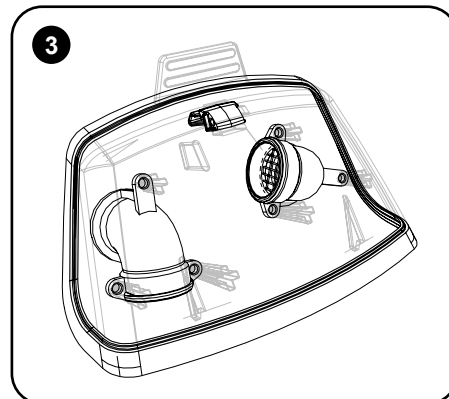

Take the separator to a suitable cleaning station.

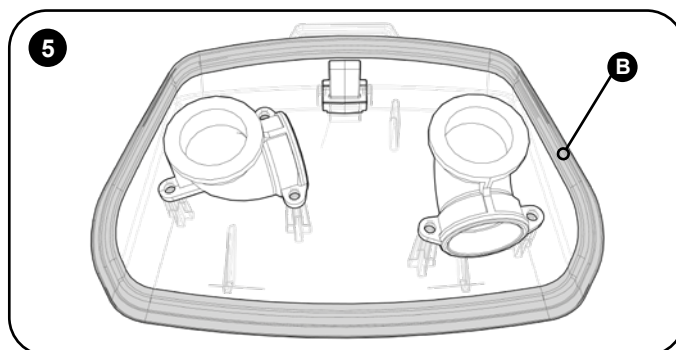
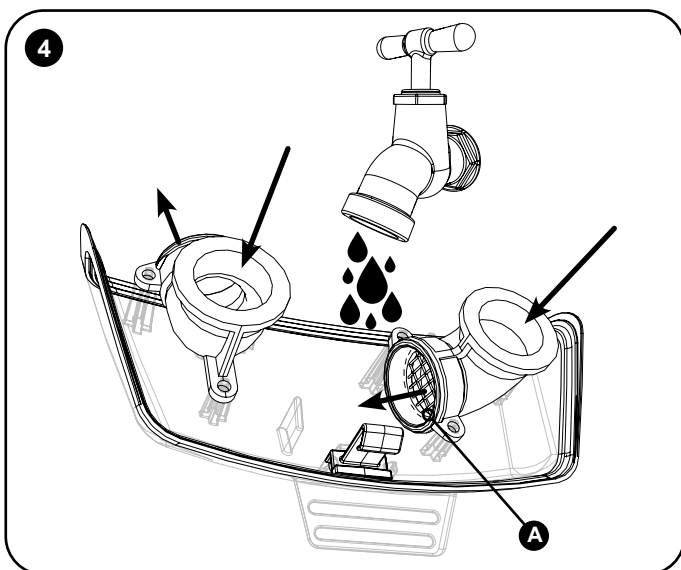

Once the separator has been removed, wash thoroughly under a tap making sure to run water through the tubes and to clean the grid filter (A). Once clean thoroughly check the rubber seal for any damage or cracks (B). If any damage or cracks are found on the rubber seal replace the separator. Failure to replace could cause loss in suction and machine performance.

### Clean water tank outlets

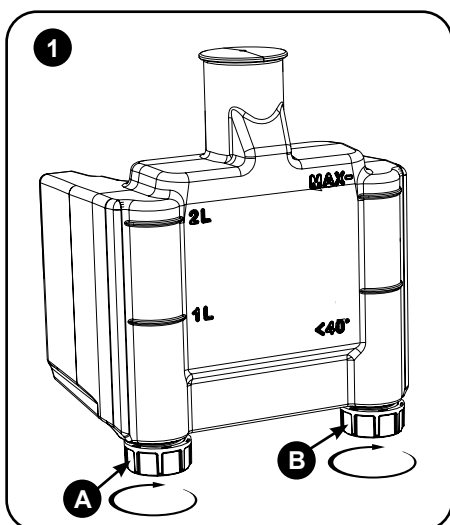

Make sure the clean water tank is empty. Unscrew the two clean water outlets, A and B.

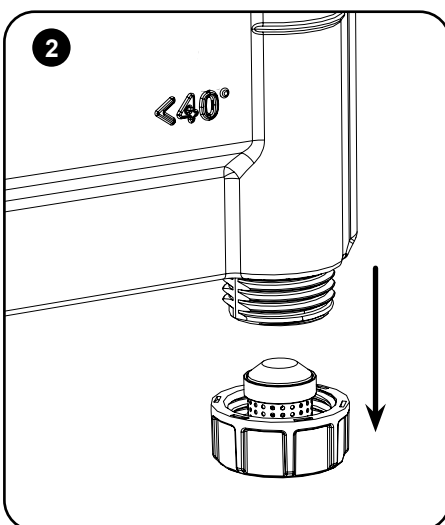

Remove the clean water outlets from the clean water tank.

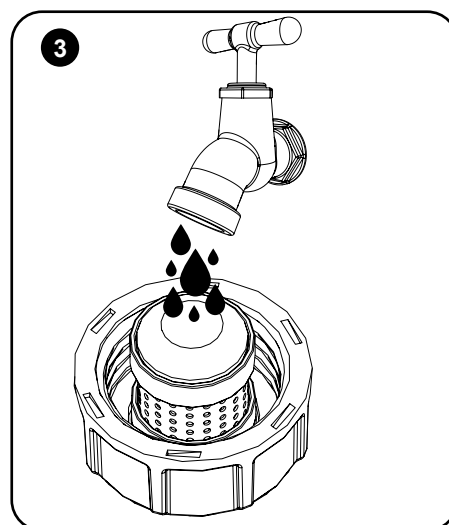

Wash the clean water outlets thoroughly under a tap, make sure the filter is clean with no blockages. Check for any damage (if any damage is found replace the clean water outlets).

## Float valve removal and cleaning

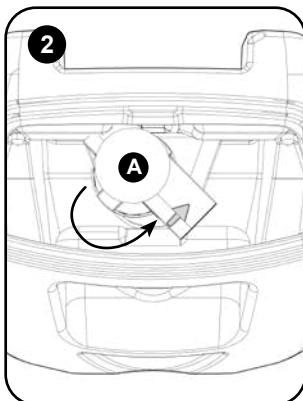
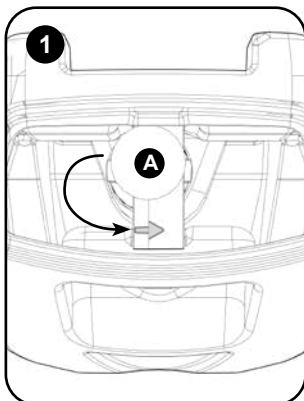

To remove the float valve twist the red retainer clip in the direction shown by the arrow on the retainer clip.

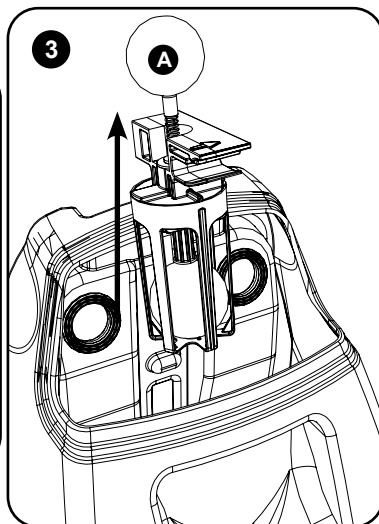

Lift the float valve from the tank, wash and inspect for damage.

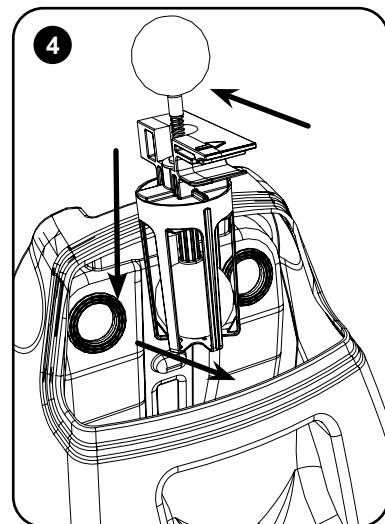

Place the float valve back down into the tank.

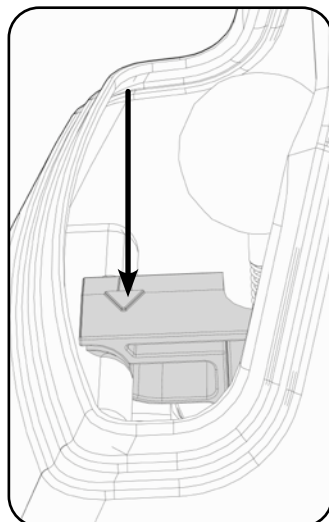
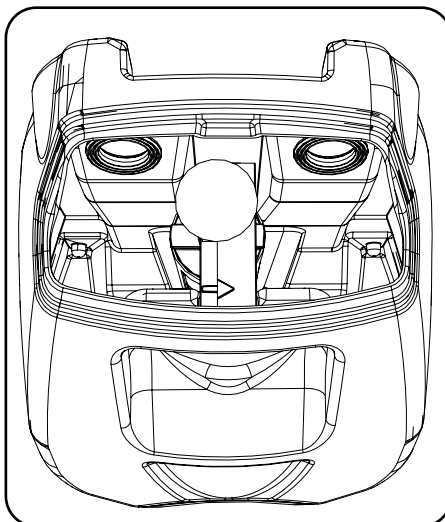
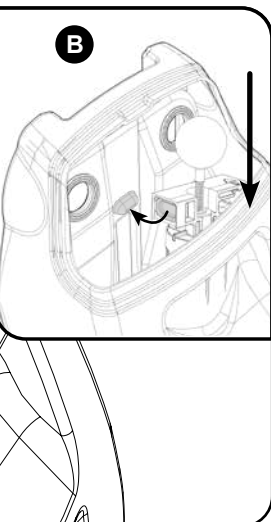
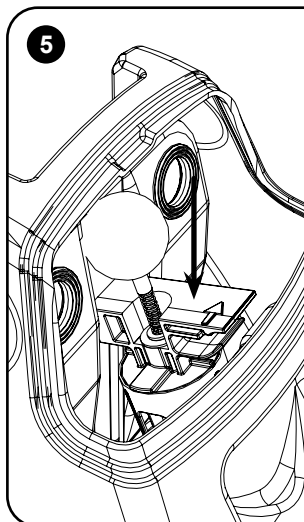

Tilt forwards at a slight angle making sure the protruding nub fits into the recess on the float valve (B). Press down firmly on the arrow and the float valve will click into place.



### **WARNING!** **DO NOT PULL ON THE FLOAT BALL (A)**

**PULLING ON THE FLOAT BALL WILL CAUSE IT TO BREAK AND THE VACUUM SHUT OFF WILL FAIL.**



## Emptying Tanks

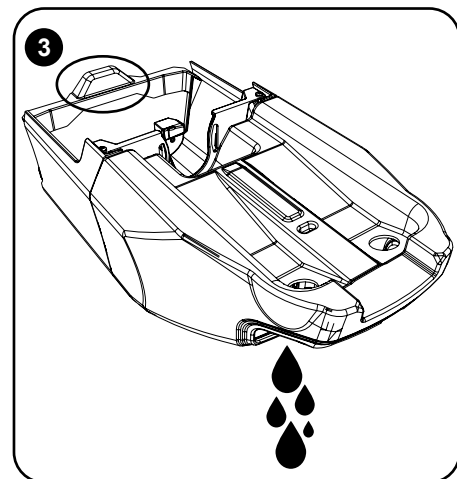
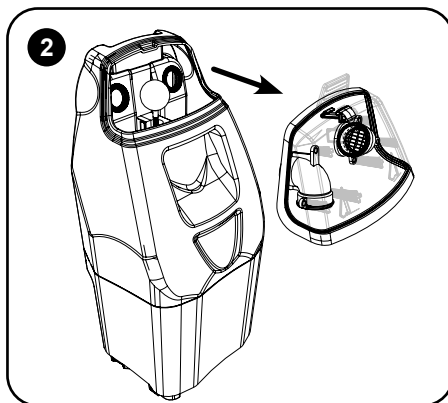
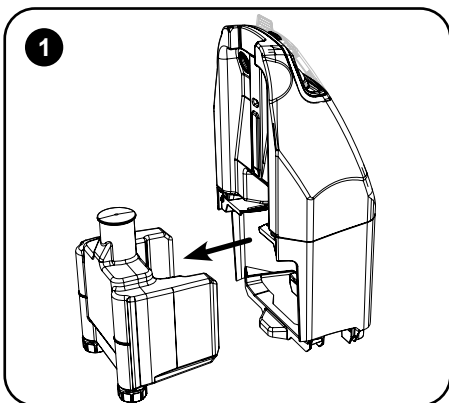

When finished using the machine it is good practise to empty and clean the tanks of the machine.

To do this firstly remove the tank assembly from the machine ( see set up ),

1. Remove the clean water tank from the main tank body and empty.

2. Remove the separator from the tank.

3. Pick up the tank, use the base shown as a handle, tip the contents into a suitable drain, rinse the tanks and repeat the emptying process. Refit the clean water tank and separator and place back onto the machine.

*Note: If the machine is to be left for long periods between use, ensure the clean water tank is emptied.*

## Changing the Floor Tool Blades



**Always make sure that the machine is switched off and the battery is removed prior to any maintenance.**

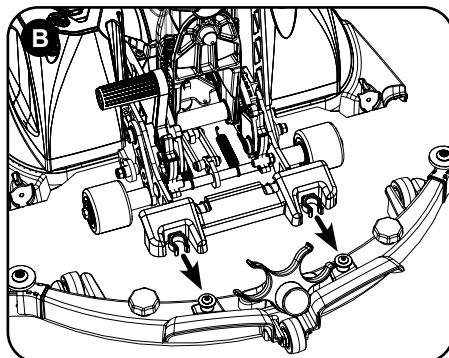
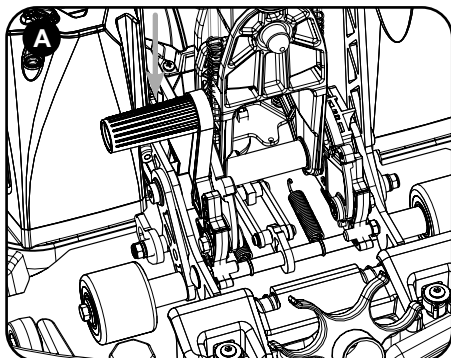

To change the floor-tool, firstly lower the floor-tool using the left side floor-tool lowering foot pedal (A).

Pull the floor-tool away from the machine (B).

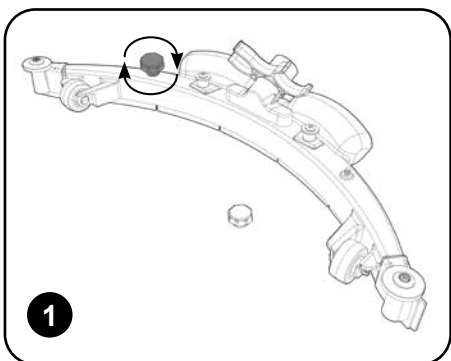

Unscrew the two knobs securing the blade holder (1).

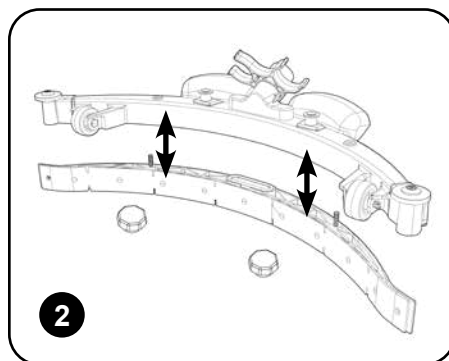

Remove the blade holder (2).

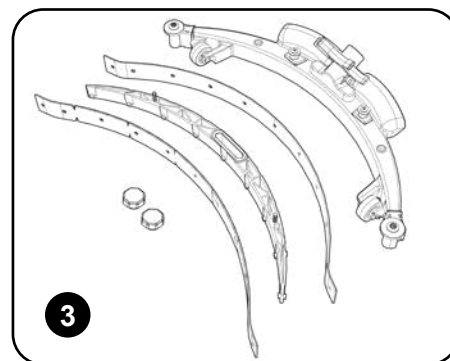

Replace the Squeegee blades using (903531) replacement blade set (Fig.3), fitting the blades on to the moulded location lugs.

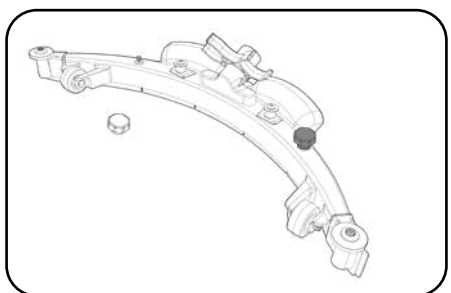

### Refitting the Floor Tool Blades

Refit the blade holder, retain using the two outer knobs. Make sure the slotted blade goes to the front of the floor-tool.

Refit the floor-tool using the two central knobs to the floor-tool. Make sure the end holes on both squeegee blades are positioned correctly on 'T' shaped clip mouldings! (A)

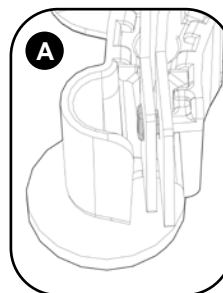

### Floor Tool Overview

1. Retaining knobs x 2
2. Front blade (Slotted / Reversible)
3. Blade carrier
4. Rear blade
5. Floor tool main body

**NOTE:** The blades are designed to be reversible and rotated giving 4 usable surfaces (front, back, top and bottom, thus extending their useful working life).

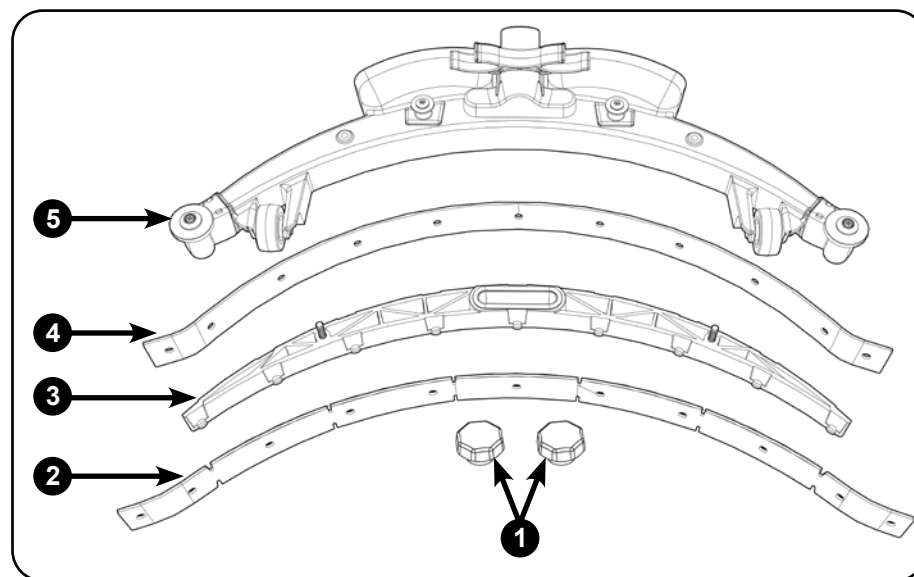

Remove the tank assembly from the front of the machine using the inset handle on the front of the tank assembly, lift the tank assembly straight up (A). Pull the tank assembly from the machine and place on the ground.

The battery can then be lifted from the machine for storage or charging using the handle on the battery (B).

*For information relating to the operation and charging of your battery please refer to the battery and charger original operating instructions.*

**Daily**  
**Keep the machine clean.**  
**Ensure brushes / pads / squeegee / filters are in good condition.**  
**Check for any worn or damaged parts and replace immediately.**  
**Drain and rinse dirty water tank after every use.**

**Weekly – as daily and –**  
**Check brush / pad and deck skirt, wipe and rinse.**  
**Check floor tool blades for wear and wipe clean.**  
**Clean separator assembly including filter and check condition of seal.**  
**Flush out system with clean water and clean filters.**

**TwinTec  
Maintenance**

Notes:

## Specifications

| Model - NUC244NX   |  |   |                   |   |   |        |
|--|--|---|-------------------|---|---|--------|
| Brush / Pad Weight<br>in cleaning mode                             | Brush / Pad Pressure<br>in cleaning mode                     | Cleaning Area   | Brush Motor Power | Brush Speed                             | Brush / Pad Width                       |        |
| 12.5 kg  | Brush 18.95 g/cm <sup>2</sup><br>Pad 20.10 g/cm <sup>2</sup> | 1320 m <sup>2</sup> /Hour<br>@ 3 km/h                 | 2 x 200W          | 140 rpm                                 | 2 x 220mm<br>(440mm)                    |        |
| Vac Motor Max Power  | Clean Tank Capacity  | Waste Tank Capacity                                   | Water Ingress     | Gross Weight<br>(With liquid & battery) | Nett Weight<br>(No liquid & No battery) | Rating |
| 100W   | 2.2 L  | 3 L   | IPX3              | 25.5 kg                                 | 21.3 kg                                 | 500W   |
| *Run Time<br>(Battery life)  | *Recharge Time   | Dimensions  |                   | Hand Arm Vibration                      | Sound Pressure                          |        |
| *60-80 Min   | *1 Hour (80%)<br>*2 Hours (100%)                             | Width = 520 mm<br>Length = 450 mm<br>Height = 1200 mm |                   | ≤ 2.5 m/s <sup>2</sup>                  | LpA ≤ 70 dB(A)                          |        |
| *Run and Recharge times may vary dependent on ambient temperature. |  |   |                   |   |   |        |

## Troubleshooting

| PROBLEM                   | CAUSE   | SOLUTION   |
|---------------------------|---|--|
| Machine will not operate  | Battery not connected<br>Low battery charge   | Connect battery (page 6)<br>Charge battery (page 12)   |
| Vacuum will not operate   | Vacuum not turned on  | Turn on vacuum (page 7)  |
| Poor water pick-up        | Waste-water tank full<br>Clogged / blocked squeegee hose<br>Loose hose connections<br>Separator filter clogged / blocked<br>Poor separator seal<br>Damaged separator seal<br>Damaged / split vacuum hose<br>Damaged floor-tool blades<br>Low battery charge | Empty waste-water tank (page 10)<br>Remove and clean (page 4)<br>Push tight connections (page 4)<br>Clean (page 9)<br>Clean and refit (page 9)<br>Renew (Spare parts page 16)<br>Renew (Spare parts page 16)<br>Renew (Spare parts page 16)<br>Recharge battery - see battery charger manual |
| No brush / scrub function | No brushes fitted<br>Brush overloaded   | Check and fit (page 4)<br>Reset the machine and decrease the brush load  |
| Little or no water flow   | Clean-water tank empty<br>Incorrect water flow setting<br>Blocked clean water tank outlets  | Fill clean-water tank (page 5)<br>Adjust fluid control levers (page 6)<br>Remove and clean (page 9)  |

**Failure to rectify the problem or in the event of a breakdown contact your Numatic dealer or Numatic Technical helpline +44 (0)1460 269268**



## About the Machine

### Rating Label

|    |                             |
|----|-----------------------------|
| 1  | Company Name & Address      |
| 2  | Machine Description         |
| 3  | Battery Voltage             |
| 4  | Noise Emission              |
| 5  | Hand Arm Vibration          |
| 6  | Weight (ready to use)       |
| 7  | Ingress Protection Rating   |
| 8  | Gradient symbol             |
| 9  | EU Importers info           |
| 10 | Battery part number         |
| 11 | Machine QR code             |
| 12 | Approvals Mark              |
| 13 | WEEE symbol                 |
| 14 | Part Number                 |
| 15 | Machine yr/wk Serial number |
| 16 | Numatic Support             |

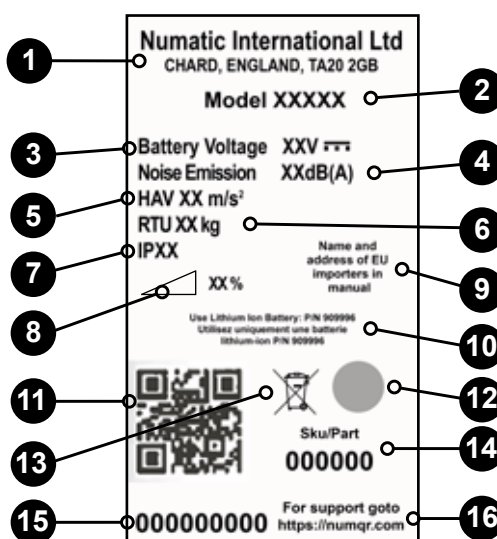

### WEEE (Waste, Electrical and Electronic Equipment)

Scrubber dryer Accessories and packaging should be sorted for environmentally-friendly recycling.

Only for EU countries.

Do not dispose of scrubber-dryer into household waste.

According to the European Directive 2012/19/EU on waste electrical electronic equipment and its incorporation into national law.

Scrubber-dryers that are no longer suitable for use must be separated, collected and sent for recovery in an environmentally-friendly manner.



PPE (Personal protective equipment) that may be required for certain operations.

|                             |                 |                     |               |                        |
|-----------------------------|-----------------|---------------------|---------------|------------------------|
|                             |                 |                     |               |                        |
| Ear Protection              | Safety Footwear | Head Protection     | Safety Gloves |                        |
|                             |                 |                     |               |                        |
| Dust / Allergens Protection | Eye Protection  | Protective Clothing | Hi-Vis Jacket | Caution Wet Floor Sign |

NOTE: A risk assessment should be conducted to determine which PPE should be worn.

### Safety Critical Component:

Charging Leads: HO5VV-F x 0.75mm² x 3 CORE  
Battery Charger: 100 - 240 Volt

***In the event of a breakdown contact  
your Numatic dealer or the  
Numatic Technical  
help line +44 (0)1460 269268***



**ORIGINAL INSTRUCTIONS  
READ MANUAL BEFORE USE**

## Information for Scrubber Dryer

| COMPONENT      | INTERVAL        | INSPECT FOR                                  |
|----------------|-----------------|--|
| Mains Lead     | DAILY           | Scuffing, cracks, splits, conductors showing |
| Brushes        | DAILY           | Bristle damage, wear, drive collar wear      |
| Squeegee Blade | BEFORE EACH USE | Wear, cracks, splits                         |
| Filters        | BEFORE EACH USE | Clogging and debris retention                |
| Tanks          | AFTER EACH USE  | Rinse dirty water tank after use             |



As with all electrical equipment care and attention must be exercised at all times during its use, in addition to ensuring that routine and preventative maintenance is carried out periodically in order to ensure its safe operation. Operators shall be adequately instructed as to the correct use of the machine.

Failure to carry out maintenance as necessary, including the replacement of parts to the correct standard could render this equipment unsafe and the manufacturer can accept no responsibility or liability in this respect. When ordering spare parts always quote the Model Number / Serial Number specified on the Rating Plate. Warning do not use on slopes exceeding 2%.

This appliance is not intended for use by persons (including children) with reduced physical, sensory or mental capabilities, or lack of experience and knowledge. Children should be supervised to ensure that they do not play with the appliance.

Only use brushes provided with the appliance or those specified in the instruction manual.  
The use of other brushes may impair safety.

A full range of brushes and accessories are available for this product.

Only use brushes or pads which are suitable for the correct operation of the machine for the specific task being performed.

It is essential that this equipment is correctly assembled and operated in accordance with current safety regulations.

When using the equipment always ensure that all necessary precautions are taken to guarantee the safety of the operator and any other persons who may be affected.

Wear non slip footwear when scrubbing. Use a respiratory mask in dusty environments.

When cleaning, servicing or maintaining the machine, replacing parts or converting to another function the battery should be removed.

Machines left unattended shall be secured against unintentional movement.

When detergents or other liquids are used, read the manufacturer's instructions.



This machine is not suitable for picking-up hazardous dust.  
The machine is not to be stored outdoors in wet conditions.  
This machine is for indoor use only.

**NOTES: This machine is intended for commercial use, for example in hotels, schools, hospitals, factories, shops and offices for other than normal housekeeping purposes. This product meets the requirements of IEC 60335-2-72**



**DO**

- Ensure only competent persons unpack / assemble the machine.
- Keep your machine clean.
- Keep your brushes in good condition.
- Replace any worn or damaged parts immediately.
- Ensure that the work area is clear of obstructions and / or people.
- Ensure that the working area is well illuminated.
- Pre-sweep the area to be cleaned.



**DON'T**

- Use steam cleaners or pressure washers to clean the machine or use in the rain.
- Allow any inexperienced repairs. Call the experts.
- Allow the machine to be used by inexperienced or unauthorised operators or without appropriate training.
- Use the machine without the solution tanks properly positioned on the machine, as shown in the instructions.
- Expect the machine to provide trouble-free, reliable operation unless maintained correctly.
- Run the machine over power cable during operation.
- Lift or pull the machine by any of the operating triggers, use the main handle.

| Part No. | SPARES & ACCESSORIES           | Part No. | SPARES & ACCESSORIES                 |
|----------|--------------------------------|----------|--------------------------------------|
| 909996   | BATTERY                        | 911798   | BALL SHUT OFF ASSEMBLY               |
| 911334   | LITHIUM BATTERY CHARGER        | 911502   | SEPARATOR MOULDING & SEAL OVER MOULD |
| 912365   | CHARGER CABLE (UK)             | 911931   | NYLO SCRUB BRUSH SET PACK OF 2       |
| 912361   | CHARGER CABLE (EURO)           | 912353   | RED PADS PACK OF 10                  |
| 912364   | CHARGER CABLE (SWISS)          | 912354   | WHITE PADS PACK OF 10                |
| 912363   | CHARGER CABLE (SOUTH AFRICAN)  | 912352   | GREEN PADS PACK OF 10                |
| 912360   | CHARGER CABLE (AUSTRALIAN)     | 912356   | MELAMINE PADS PACK OF 2              |
| 912362   | CHARGER CABLE (NORTH AMERICAN) | 912355   | DIAMOND PADS PACK OF 2               |
| 911518   | SERILOR BLADE SET (FRONT)      | 911844   | DRIVE BOARD PACK OF 2                |
| 911519   | SERILOR BLADE SET (BACK)       | 911500   | CLEAN WATER TANK                     |
|          |                                | 911499   | WASTE WATER TANK                     |
|          |                                |          |                                      |
|          |                                |          |                                      |
|          |                                |          |                                      |

## Schematic Diagram

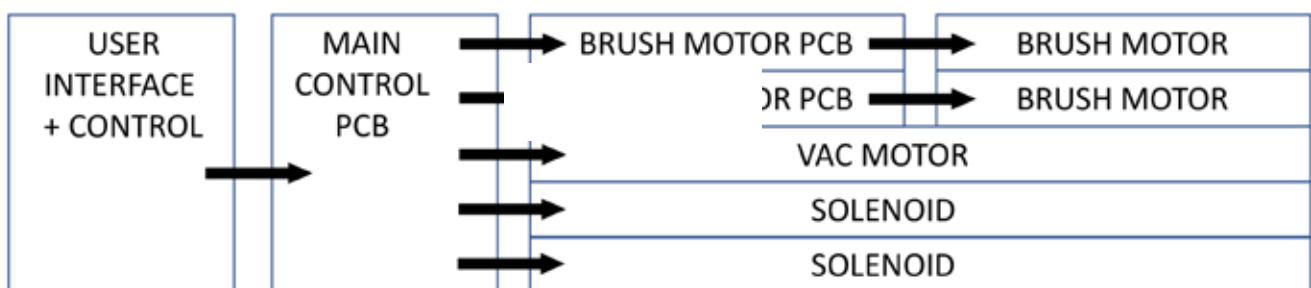

## Lithium-Ion Battery Warranty

## Warranty: Commercial Use

- a. Batteries are warranted (1 Year) providing all battery care rules are followed
  - b. To claim warranty the following details must be supplied
    - i. Serial number of the machine
    - ii. Battery date code
    - iii. Date purchased
    - iv. Proof of Purchase
    - v. Maintenance history and charging regime
- Failure to use the correct Numatic charger will void your warranty.

# Numatic International Warranty

Numatic International Limited warrant to the original purchaser that its products are free of defects in both material or workmanship for the period shown below:-

|  |                     |
|--|---------------------|
| Homecare and Cleancare Vacuum cleaners.....          | 2 Years             |
| Rotary Floor Machines.....                           | 2 Years             |
| Twintec Auto Scrubber Dryer.....                     | 1 Year              |
| Vario Ride-On Scrubber Dryer.....                    | 1 Year / 1500 hours |
| Mopping, Compacts, Combi and Servocare Products..... | 1 Year              |
| Individual Accessories and Spare Parts.....          | 6 Months            |

Note: This warranty expressly excludes consumable parts such as carbon brushes, floor brushes, mops, batteries etc, that are considered replaceable from time to time during the normal working life of the machine.

A. The warranty period commences from the date the goods are purchased.

B. All warranty claims must be processed through the Dealer from whom the equipment was purchased. The Dealer will co-operate with the purchaser throughout the warranty claims procedure and will arrange any necessary repairs using genuine Numatic parts.

C. If the original Dealer is no longer able to fulfil his obligations please contact Numatic International Limited with full details of the claim and proof of purchase so that this may be processed without delay.

D. Any warranty claim can only relate to the specific part that is proven to be at fault and for which a replacement will be supplied but cannot be extended to constitute a claim against the complete machine.

E. Numatic International will supply the Dealer with any warranty parts required, subject to the claim being validated, after return of the faulty items in accordance with Numatic International Limited's General Conditions of Sale.

F. Claims will not be accepted if they are the result of fair wear and tear, misuse or abuse of any kind.

G. No replacement will be given unless the appropriate evidence of the validity of the claim has been provided to the satisfaction of Numatic International Limited.

H. Numatic International Limited reserve the right to charge for any unnecessary work carried out as a result of an invalid claim.

I. No variation to this warranty may be made or implied by any member of Numatic International Limited or its Dealers unless such variation is in writing and authorised by the Company

## Numatic

Numatic International Limited. Chard, Somerset, TA20 2GB

Telephone: 01460 68600 Fax: 01460 68458

© Numatic International Limited

|                                |  |   |
|--------------------------------|--|---|
| UKCA Declaration of Conformity |  |   |
| Manufacturer:                  | <br>Numatic International Limited<br>Chard<br>Somerset<br>TA20 2GB<br>www.numatic.co.uk<br>TTB244, NUC244 |   |
| Product:                       | Floor Treatment - Walk Behind – Commercial - Battery   |   |
| Description:                   | We, Numatic hereby declare under our sole responsibility, that the above-mentioned product(s) is/are in conformity with the following directives and standards.                              |   |
| S.I. 2008: 1597                | Supply of Machinery Regulations  | EN60335-1:2012 + AC:2014 + A11:2014 + A13:2017<br>EN60335-2-72:2012<br>EN62233:2008 |
| S.I. 2016: 1091                | EMC Regulations  | EN55014-1:2017 + A11:2020<br>EN55014-2:1997 + A1:2001 + A2:2008                     |
| S.I. 2012: 3032                | RoHS Regulations   |   |

|  |  |  |
|--|--|--|
| EU, EC, EL, UE, ES:<br><b>Declaration of Conformity</b><br>Prohlášení o shodě<br>Konformitätserklärung<br>Overensstemmelseerklæring<br>Declaración de conformidad<br>Vastavusdeklaratsioon<br>Déclaration de conformité  | Декларация за съответствие<br>Δηλώση συμμόρφωσης<br>Megfelelőségi nyilatkozat<br>Dichiarazione di conformità<br>Försäkran om överensstämmelse<br>Izjava o skladnosti<br>Vaatumustenmukaisuusvakuutus   |  |
| <b>Manufacturer:</b> / Výrobce / Hersteller / Fabrikant / Fabricante / Toetja / Fabricant / произво­дитель / Κατασκευαστής / Gyártó / Fabricante / Gamintojas / Fabrikant / Producent / Fabricante / Producent / Producător / произво­дитель / Tilvekkare / Proizvajalca / Valmistaja:   | Numatic International Limited<br>Chard<br>Somerset<br>TA20 2GB<br>www.numatic.co.uk<br>TTB244, NUC244  |   |
| <b>Product:</b> / Προϊόν / Termék / Prodotto / Produkta / Artikel / Produkt / Products / Produkt / Produkt / Товар / Produkt / Izdelek / Tuote: /<br><b>Description:</b> / Popis / Beschreibung / Beskrivelse / Descripción / Kirjeldus / La description / Описание / Περιγραφή / Leirás / Descrição / Aipludinimas / Omschrijving / Beskrivelse / Descrição / Opis / Descriere / Описание / Beskrivning / Opis / Kuvaus:  | Product / Toetja / Fabricant / Gamintojas / Fabrikant / Producent / Fabricante / Producent / Producător / произво­дитель / Tilvekkare / Proizvajalca / Valmistaja:<br>Floor Treatment – Walk Behind – Commercial - Battery   |  |
| <b>GB We, Numatic hereby declare under our sole responsibility, that the above-mentioned product(s) is/are in conformity with the following directives and standards.</b><br><b>CZ</b> My, Numatic prohlašujeme na svou výlučnou odpovědnost, že výše uvedený výrobek je ve shodě s následujícími směrnici a normami.<br><b>DE</b> Wir, Numatic erklären in alleiniger Verantwortung, dass das oben genannte Produkt den folgenden Richtlinien und Normen entspricht.<br><b>DK</b> Vi, Numatic erklærer hermed under eget ansvar at ovennævnte produkt(er) er i overensstemmelse med følgende direktiver og standarder.<br><b>ES</b> Nosotros, Numatic declaramos bajo nuestra única responsabilidad que el producto antes mencionado está en conformidad con las siguientes directivas y normas<br><b>EE</b> Meie, Numatic käesolevaga kinnitame ja kanname ainuiskulust vastutust, et eespool nimetatud toode on kooskõlas järgmistele direktivide ja<br><b>FR</b> Numatic déclare sous notre seule responsabilité que le produit mentionné ci-dessus est conforme aux directives et normes suivantes. | <b>BG</b> Ние, Numatic С настоящото декларираме на своя лична отговорност, че посочените по-горе продукти са в съответствие със следните Директиви и стандарти.<br><b>GR</b> Εμείς, Numatic δηλώνουμε με αποκλειστική μας ευθύνη, ότι το προαναφερθέν προϊόν συμμορφώ­εται με τις ακόλουθες οδηγίες και πρότυπα.<br><b>HU</b> Mi, Numatic kijelentjük, egyedüli felelősséggel, hogy a fent említett termék megfelel az alábbi irányelveknek és szabványoknak<br><b>IT</b> Noi, Numatic dichiara sotto la propria responsabilità, che il prodotto di cui sopra è conforme alle seguenti direttive e norme.<br><b>LT</b> Mes, "Numatic pareiškiu vienašališkos atsakomybės, kad pirmiau minėtas produktas atitinka šias direktyvas ir standartus<br><b>NL</b> We verklaren Numatic hierbij op eigen verantwoordelijkheid, dat het bovengenoemde product voldoet aan de volgende richtlijnen en normen<br><b>NO</b> Vi, Numatic erklærer herved under eget ansvar, at det ovennevnte produktet er i samsvar med følgende direktiver og standarder | <b>PT</b> Nós, a Numatic declaramos, sob nossa exclusiva responsabilidade, que o produto acima mencionado está em conformidade com as direttrizes e normas a seguir.<br><b>PL</b> My, Numatic Niniejszym oświadczamy z pełną odpowiedzialnością, że wyżej wymieniony produkt jest zgodny z następującymi dyrektywami i normami.<br><b>RO</b> Noi, Numatic Prin prezenta declarăm pe propria răspundere, că produsul mai sus menționat este în conformitate cu următoarele standarde și directive.<br><b>RU</b> Мы, Нуматик овим изъавляем под луном одговорношћу, да наведе­ног произво­д је у складу са следећим директивама и стандардима.<br><b>SE</b> Vi Numatic förklarar härmed under eget ansvar att ovan nämnda produkt överensstämmer med följande direktiv och normer.<br><b>SI</b> Mi, Numatic izjavljamo s polno odgovornostjo, da je zgoraj omenjeni izdelek v skladu z naslednjimi smernicami in standardi.<br><b>FI</b> Me, Numatic täten vakutamme omalla vastuulla, että edellä mainittu tuote on yhdenmukainen seuraavien direktiivien ja standardien mukaisesti |
| <b>2006/42/EC</b>  | <b>Machinery Directive</b>   | <b>EN60335-1:2012 + AC:2014 + A11:2014 + A13:2017<br/>EN60335-2-72:2012<br/>EN62233:2008</b>   |
| <b>2014/30/EU</b>  | <b>EMC Directive</b>   | <b>EN55014-1:2017 + A11:2020<br/>EN55014-2:1997 + A1:2001 + A2:2008</b>  |
| <b>2011/65/EU</b>  | <b>RoHS Directive</b>  |  |

Authorised Signatory: Mr. Matthew Coles

Position: Head of Technology  
Numatic International Limited  
Chard,  
Somerset, TA20 2GB, UK

Signed:  Date: 04<sup>th</sup> May 2022



**This Machine Has Been Packed  
With The Following**

Scrub Brush / Pad

☐

Squeegee Assembly

☐

Charger / Lead & Battery Pack

☐

Distributed by:

# Numatic



Numatic International Limited.  
Chard, Somerset TA20 2GB ENGLAND  
Tel: 01460 68600 [www.numatic.co.uk](http://www.numatic.co.uk)

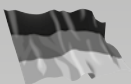

Numatic International GmbH. Fränkische Straße 15–19  
D-30455 Hannover, DEUTSCHLAND  
Tel: 05 11 98 42 16 0 [www.numatic.de](http://www.numatic.de)

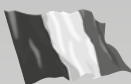

Numatic International SAS. 13 / 17 rue du Valengelier  
EAE La Tuilerie, 77500 CHELLES, FRANCE  
Tel: 01 64 72 61 61 [www.numatic.fr](http://www.numatic.fr)

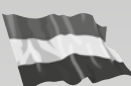

Numatic International BV, Vennootsweg 15  
2404 CG, Alphen aan den Rijn, Nederland  
Tel: 0172 467 999 [www.numatic.nl](http://www.numatic.nl)

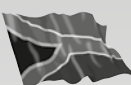

Numatic International (Pty.) Ltd.  
16th & Pharmaceutical Roads, Midrand, Gauteng,  
SOUTH AFRICA 1685  
Tel: 0861 686 284 [www.numatic.co.za](http://www.numatic.co.za)



Numatic International Schweiz AG.  
Sihlbruggstrasse 3A, 6340 Baar. SCHWEIZ  
Tel: 0041 (0) 41 76 80 76 - 0 [www.numatic.ch](http://www.numatic.ch)



Numatic International ULDA. Rua da Boa Viagem, 177  
4470.210 Maia. PORTUGAL  
Tel: +351 220 047 700 [www.numatic.pt](http://www.numatic.pt)



Numatic International SLU. C/ La Forja, 41, 08840 Viladecans  
(Barcelona), Spain  
Tel: +34 93 647 22 22 [www.numatic.es](http://www.numatic.es)

This Product has been comprehensively inspected and checked during every stage of its manufacture.  
Including an in-depth electrical safety and functionality test.

Specification subject to change without prior notice  
[numatic.com](http://numatic.com) © Numatic International Limited

913524 05/22 (A06)